



**Kitchen Cabinets & Vanities
2009 Premium**

AVAILABLE FINISHES



Natural Oak
(Cathedral Wall Door)



Ginger Maple
(Roman Arch Wall Door)



Heritage Maple
(Square Wall Door)



Sunset Maple
(Roman Arch Wall Door)



Chestnut Glaze
(Square Wall Door)

CABINETS - At A Glance

Wall Cabinets

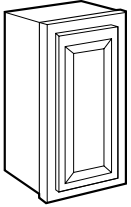

Single Door Wall:

W9" x 30" W9" x 42"
 W12" x 30" W12" x 42"
 W15" x 30" W15" x 42"
 W18" x 30" W18" x 42"
 W21" x 30" W21" x 42"

All wall cabinets have two 5/8" adjustable plywood shelves. Door is reversible.

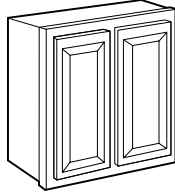

Double Door Wall:

W24" x 30" W24" x 42"
 W27" x 30" W27" x 42"
 W30" x 30" W30" x 42"
 W36" x 30" W36" x 42"
 W42" x 30" W42" x 42"

All wall cabinets have two 5/8" adjustable plywood shelves.

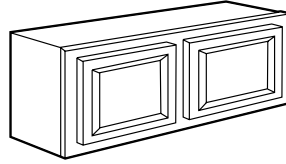

Double Door Wall Bridge:

W30" x 12" W36" x 12"
 W30" x 15" W33" x 15"
 W36" x 15" W36" x 15"
 W30" x 24" W36" x 24"

No shelves.

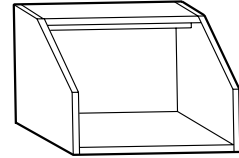

Microwave Cabinet:

MC3018 (30" W X 18" H)

Mounts under Double Door Wall Bridge

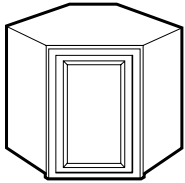

Wall Diagonal Corner:

WDC24" x 30"
 WDC24" x 42"

Door is reversible.
 All wall cabinets have two 5/8" adjustable plywood shelves. Start installation with a corner wall cabinet if kitchen has a corner.

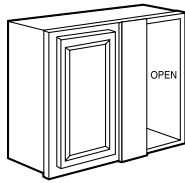

Wall Blind Corner:

WBC27" x 30"
 WBC27" x 42"

Cabinet is reversible Left to Right.
 All wall cabinets have two 5/8" adjustable plywood shelves. Pull cabinet away from wall corner 0-2" for door operation.

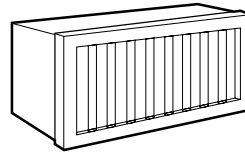
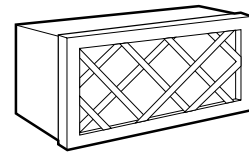

Plate Rack:

W3015PL (30" W X 15" H)



Wine Rack:

W3015WR (30" W X 15" H)

Accessories

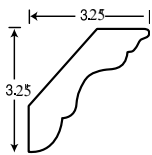

Crown Molding:

CM8
 96" length x 3 1/4" width



Sculptured Valance

VAS48"i

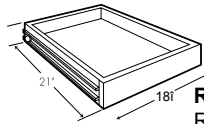

Roll Out Tray
 RD18

Fits in any base or pantry cabinet larger than 18"

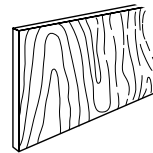

End & Island Panel

Finished Island Back Panel: (ISLAND pnl)

34.5" H x 48" W x 1/4" D

Finished End Panel: (BEP)

34.5" H x 24" W x 1/4" D

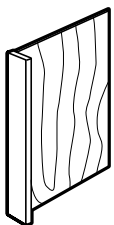

Dishwasher Base End Panel

BEP 3RT
 34.5" H x 24" W x 5" D

Refrigerator End Panel (RP96):

24" x 96"

Refrigerator End Panel (RP84):

24" x 84"

Includes optional 3" trimmable filler finished on both sides



Wall Filler Strip

FS30" (3" x 30")
 FS42" (3" x 42")

Can be cut down to any size



Base Filler w/ Toe Kick:

BF3 (3" x 34 1/2")

(Line art may not reflect exact specifications.)

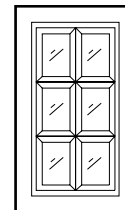

Mullion Doors

WDC2430GD
 WDC2442GD
 W1530GD
 W1542GD
 W1830GD
 W1842GD

Fits WDC2430
 Fits WDC2442
 Fits W1530 or W3030
 Fits W1542 or W3042
 Fits W1830 or W3630
 Fits W1842 or W3642

Note: Glass not included.

All wall cabinets have two 5/8" adjustable plywood shelves & are Finished on every surface but Back. Door is reversible.

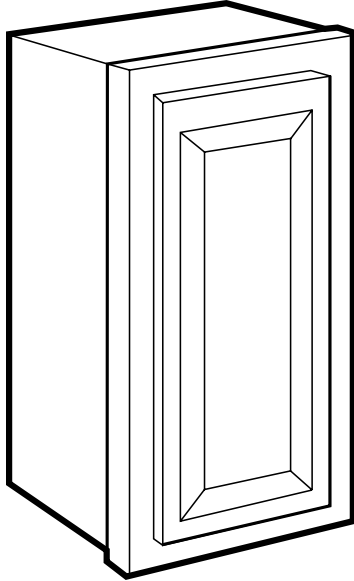

Wall Cabinets ñ Single Door 30" High

ITEM	Description
W0930	9î x 30î x 12î Single Door Wall Unit
W1230	9î x 30î x 12î Single Door Wall Unit
W1530	15î x 30î x 12î Single Door Wall Unit
W1830	18î x 30î x 12î Single Door Wall Unit
W2130	21î x 30î x 12î Single Door Wall Unit

Wall Cabinets ñ Single Door 42" High

ITEM	Description
W0942	9î x 42î x 12î Single Door Wall Unit
W1242	9î x 42î x 12î Single Door Wall Unit
W1542	15î x 42î x 12î Single Door Wall Unit
W1842	18î x 42î x 12î Single Door Wall Unit
W2142	21î x 42î x 12î Single Door Wall Unit

Wall Cabinets ñ Single Door 15" High

ITEM	Description
W2415	24î x 15î x 12î Double Door Wall Unit
W3015	30î x 15î x 12î Double Door Wall Unit
W3315	33î x 15î x 12î Double Door Wall Unit
W331524	33î x 15î x 24î Double Door Wall Unit
W3615	36î x 15î x 12î Double Door Wall Unit
W361524	36î x 15î x 24î Double Door Wall Unit

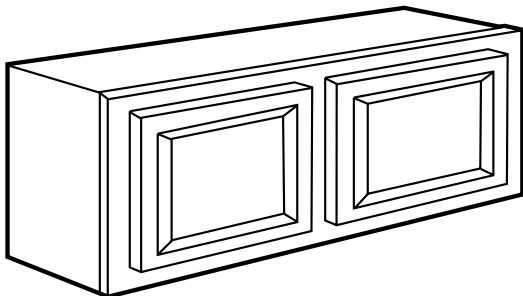

No shelves. All wall cabinets have two 5/8î adjustable plywood shelves & are Finished on every surface but Back.

Wall Cabinets ñ Single Door 18" & 24îHigh

ITEM	Description
W3018	30î x 18î x 12î Double Door Wall Unit
W3024	30î x 24î x 12î Double Door Wall Unit
W332424	33î x 24î x 24î Double Door Wall Unit
W3624	36î x 24î x 12î Double Door Wall Unit
W362424	36î x 24î x 24î Double Door Wall Unit
W361524	36î x 15î x 24î Double Door Wall Unit

All wall cabinets have two 5/8" adjustable plywood shelves & are Finished on every surface but Back.

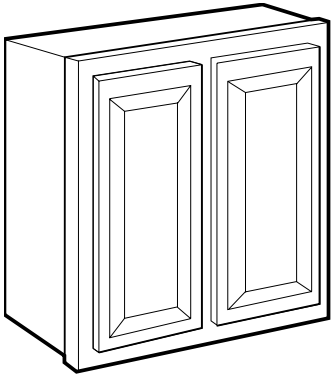

Microwave Shelf

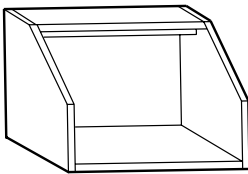

Wine Rack

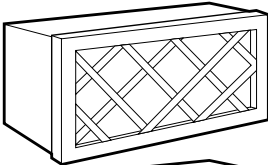
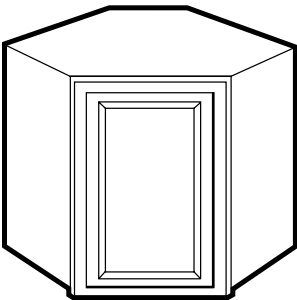
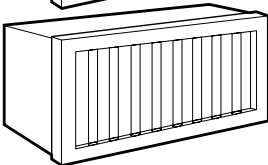
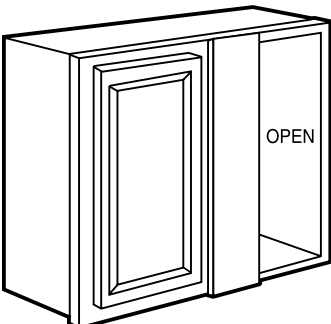

Plate Rack



Blind Corner Cabinet is Reversible



Wall Cabinets ñ Double Door 30" High

ITEM	Description
W2430	24" x 30" x 12" Double Door Wall Unit
W2730	27" x 30" x 12" Double Door Wall Unit
W3030	30" x 30" x 12" Double Door Wall Unit
W3630	36" x 30" x 12" Double Door Wall Unit
W4230	42" x 30" x 12" Double Door Wall Unit
W4242	42" x 42" x 12" Double Door Wall Unit

Wall Cabinets ñ Double Door 42" High

ITEM	Description
W2442	24" x 42" x 12" Double Door Wall Unit
W2742	27" x 42" x 12" Double Door Wall Unit
W3042	30" x 42" x 12" Double Door Wall Unit
W3642	36" x 42" x 12" Double Door Wall Unit
W4242	42" x 42" x 12" Double Door Wall Unit

Wall Cabinets ñ Microwave, Plate Rack & Wine Rack

ITEM	Description
MC3018	30" x 18" x 12" Microwave Shelf
W3015PL	30" x 15" x 12" Plate Rack
W3015WR	30" x 15" x 12" Wine Rack

Wall Cabinets ñ Diagonal Corner 30" & 42"

ITEM	Description
WDC2430	24" x 30" x 12" Wall Diagonal Corner Cabinet
WDC2442	24" x 42" x 12" Wall Diagonal Corner Cabinet

Wall Cabinets ñ Blind Corner 30" & 42"

ITEM	Description
WBC2730	27" x 30" Single Door Wall Blind Corner Cabinet
WBC2742	27" x 42" Single Door Wall Blind Corner Cabinet

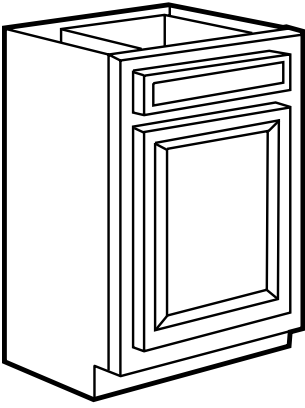

Base Cabinets & Single Door

ITEM	Description
B09	9" x 34-1/2" x 24" Single Door With Drawer Base Unit
B12	12" x 34-1/2" x 24" Single Door With Drawer Base Unit
B15	15" x 34-1/2" x 24" Single Door With Drawer Base Unit
B18	18" x 34-1/2" x 24" Single Door With Drawer Base Unit
B21	21" x 34-1/2" x 24" Single Door With Drawer Base Unit

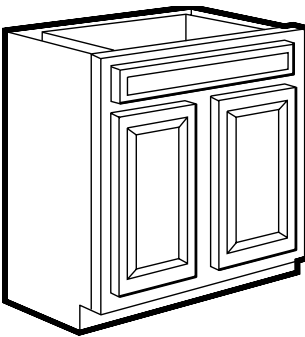

Base Cabinets & Double Door

ITEM	Description
B24	24" x 34-1/2" x 24" Double Door With Drawer Base Unit
B27	27" x 34-1/2" x 24" Double Door With Drawer Base Unit
B30	30" x 34-1/2" x 24" Double Door With Drawer Base Unit
B36	36" x 34-1/2" x 24" Double Door With 2 Drawers Base Unit

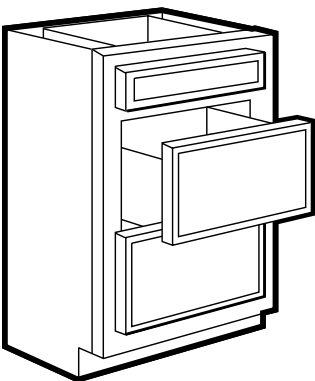

Base Cabinets & Drawer Base

ITEM	Description
DB15	15" x 34-1/2" x 24" Three Drawer Base Unit
DB18	18" x 34-1/2" x 24" Three Drawer Base Unit
DB21	21" x 34-1/2" x 24" Three Drawer Base Unit

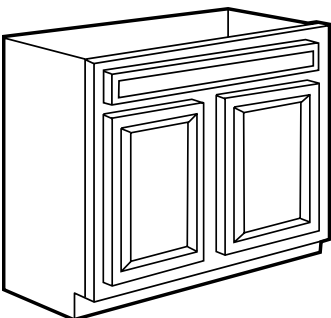

Base Cabinets & Sink Base

SB30	30" x 34-1/2 x 24" Two Door No Drawer Sink Base Unit
SB33	33" x 34-1/2 x 24" Two Door No Drawer Sink Base Unit
SB36	36" x 34-1/2 x 24" Two Door No Drawer Sink Base Unit
SB42	42" x 34-1/2 x 24" Two Door No Drawer Sink Base Unit
SB60	60" x 34-1/2 x 24" Four Door Two Drawer Sink Base Unit

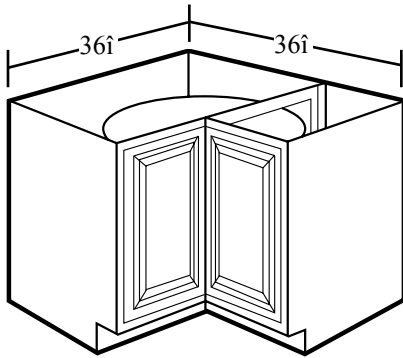

Lazy Susan Cabinet
 Features two 28" carousels. One at base, one at midpoint (12 1/2" between carousels). All wood Lazy-Susan carousels. All base cabinets include finished toe kick. 8ft. toe kicks available. Durable ball-bearing design.

Base Cabinets & Corner Cabinets

ITEM	Description
DCB3612	24" x 34-1/2" x 24" Lazy Susan Unit
BBC36	27" x 34-1/2" x 24" Blind Corner Base Unit

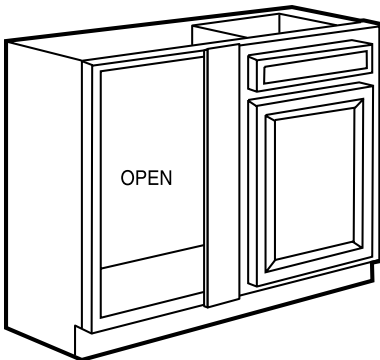

Blind Base Cabinet
 One 51" half depth adjustable plywood shelf. All base cabinets include finished toe kick. 8ft. toe kicks available. Door is reversible. Pull cabinet side away from wall corner 6"- 8 1/4".

Base Cabinets & Corner Door Front

ITEM	Description
CSF36	18" x 34-1/2" x 1" (Uses 36" of wall space in corner)

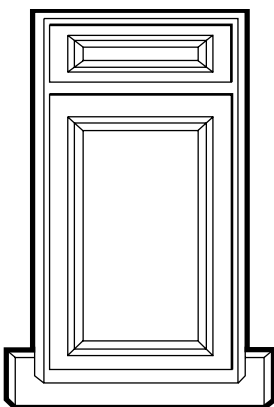

Corner Sink Front
 Diagonal Corner Frame & Toe Kick 18" W x 34-1/2" H - 1 Door (front only)

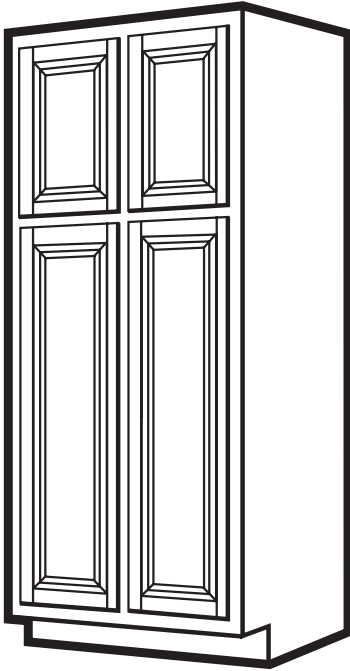

Four Door Pantry
 All base cabinets include finished toe kick. 8ft. toe kicks available.
 Two 5/8" half depth adjustable plywood shelves in bottom.

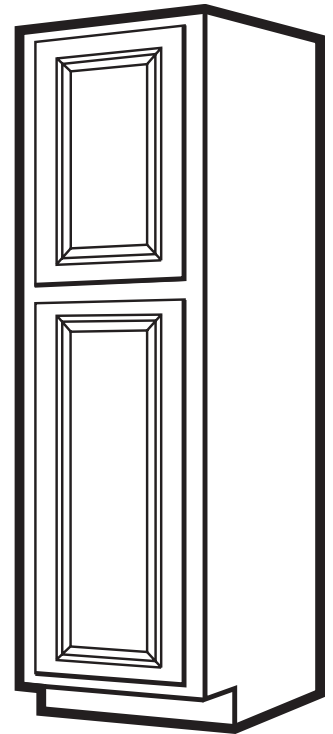

Two Door Pantry
 All base cabinets include finished toe kick. 8ft. toe kicks available.
 Two 5/8" half depth adjustable plywood shelves in bottom.

Pantry Cabinets

ITEM	Description
WP1884	18" x 84" x 24" Double Door Pantry Cabinet
WP2484	24" x 84" x 24" Four Door Pantry Cabinet
WP2496	24" x 96" x 24" Four Door Pantry Cabinet
OC3384	33" x 84" x 24" Oven Cabinet
OC3396	33" x 96" x 24" Oven Cabinet
RD18	18" Roll Out Tray (Fits in Any Cabinet Wider Than 18")

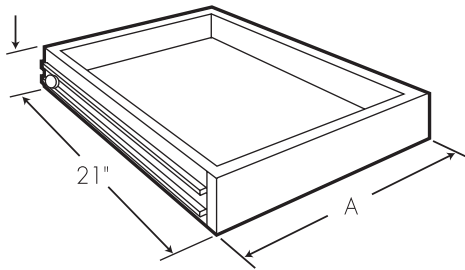

Roll Out Tray
 Will fit in any cabinet with Exterior Dimensions larger than 18".

Common Examples: B18, B36, WP1884

Oven Cabinet
 All base cabinets include finished toe kick. 8ft. toe kicks available.
 One 5/8" half depth adjustable plywood shelves in bottom.

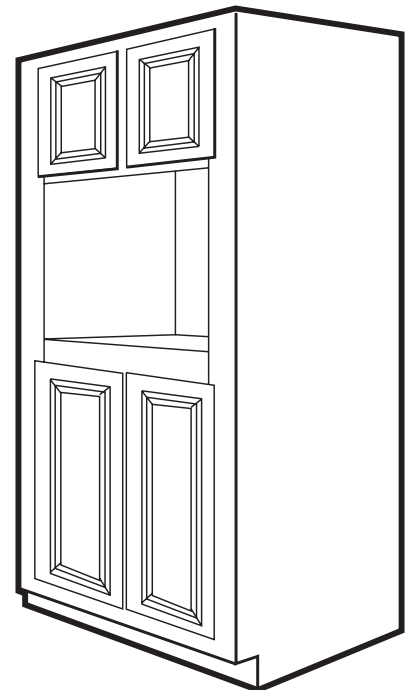

CABINETS - At A Glance

Base Cabinets

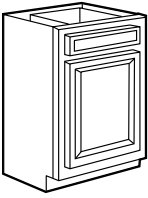

Single Door Base:

B9" B18"
B12" B21"
B15"

5/8" adjustable half depth plywood shelf. All base cabinets include finished toe kick. 8ft. to kicks available.

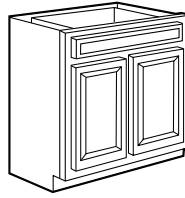

Double Door Base:

B24" B30"
B27" B33†
B36†* B42†

*One 5/8" adjustable half depth plywood shelf. All base cabinets include finished toe kick. 8ft. to kicks available. *2 drawer unit.*

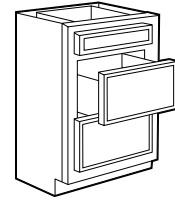

Base Drawer Unit:

DB15"
DB18"
DB21"

Three drawers. All base cabinets include finished toe kick. 8ft. to kicks available.

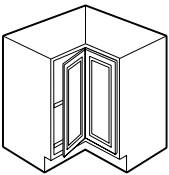

Lazy Susan:

DCB3612*

*From Back Corner 36† X 36†

Two 28" carousels. One at base one at midpoint (12 1/2" between carousels). All wood Lazy-Susan carousels. All base cabinets include finished toe kick. 8ft. to kicks available. Durable ball-bearing design.

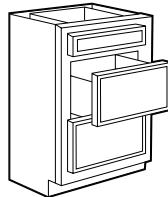

Base Drawer Unit:

DB15"
DB18"
DB24"

Three drawers. All base cabinets include finished toe kick. 8ft. to kicks available.

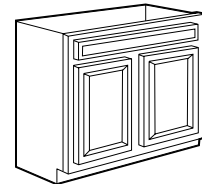

Sink Base:

SB-30** SB-36****
SB-33**** SB-42****

*All base cabinets include finished toe kick. 8ft. to kicks available. Can be used for a drop-in range. *SB-30" has one false drawer front. **SB-36" has two false drawer fronts & doors. ***SB-42" has three false drawer fronts & doors.*

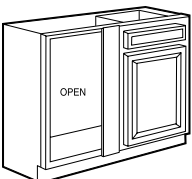

Base Blind Corner:

BBC36 L/R

One 5/8" half depth adjustable plywood shelf. Requires 42† wall space. Reversible Left or Right.

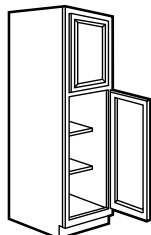

Wall Pantry:

WP1884 -2door
WP2484 - 4 door
WP2496 - 4 door

All base cabinets include finished toe kick. 8ft. to kicks available. Two 5/8" half depth adjustable plywood shelves in bottom.

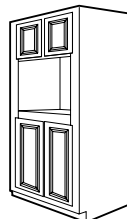

Oven Cabinet:

OC 30" x 84"
OC 30" x 96"

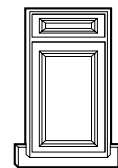

Diagonal Corner Frame:

CSF36

Uses 36† of wall space on each corner wall. Box not included.

Accessories

ITEM	Description
CM8	3 1/4" X 96" Crown Moulding
BEP3RT	3" Dishwasher End Panel
Island Panel	1/4" x 3" x 4" Single-Side Finished Plywood Panel
VAS48	48" Sculptured Valance
BF3	3" x 30" Base Filler
FS30	3" x 30" Wall Filler
FS42	3" x 42" Wall Filler
BEP	Base End Panel
RP84	84" Refrigerator End Panel
RP96	96" Refrigerator End Panel

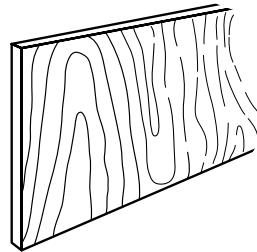
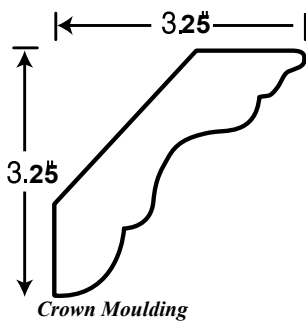

Island Panel

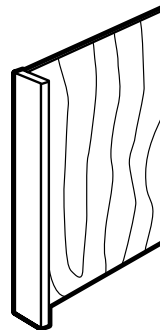

Dishwasher End Panel
Includes Optional 3" Face Piece .

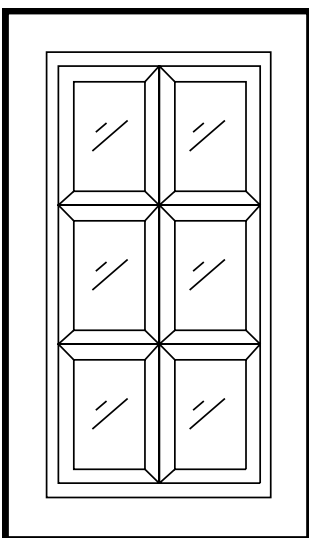
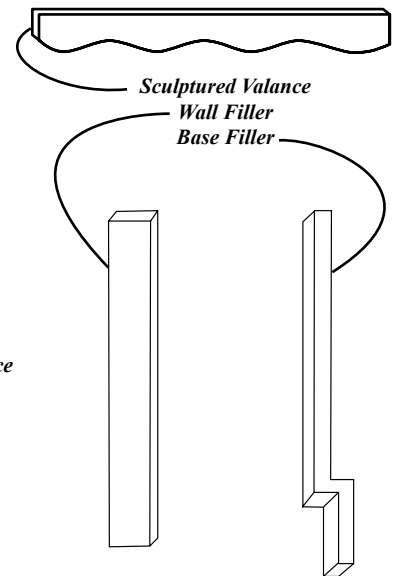

Decorative Mullion Doors

ITEM	Description
WDC2430GD	Mull Door To Fit WDC2430 Wall Diagonal Corner Cabinet
WDC2442GD	Mull Door To Fit WDC2442 Wall Diagonal Corner Cabinet
W1530GD	Mull Door To Fit W1530 or W3030 Wall Cabinet
W1542GD	Mull Door To Fit W1542 or W3042 Wall Cabinet
W1830GD	Mull Door To Fit W1830 or W3630 Wall Cabinet
W1842GD	Mull Door To Fit W1842 or W3642 Wall Cabinet